



REFILLABLE CARTRIDGE KITS FOR CANON DESK TOP PRINTERS

INSTALLATION INSTRUCTIONS AND USER GUIDE

Thank you for purchasing a refillable cartridge kit. You have just taken the first step to enjoying the cost saving and superior performance benefits of using Ink2image bulk ink. The refillable cartridge kits are simple to install, easy to use and will provide you with many hours of trouble free and lower cost printing. However, the successful use of refillable cartridges is dependent on how accurately you follow this guide during installation. Please read these instructions and familiarize yourself with the components before you start the installation. Please also remember that you are now about to start working with bulk ink instead of sealed cartridges. During installation and filling, protect the area around your printer in case of ink spillage and wear the disposable gloves included with the kit. Always have a roll of paper towel handy to clean ink from the components during filling. Finally, replace the lids on ink bottles as soon as you have used them for refilling. Remember, accidents can happen!

Refillable cartridge kits are supplied in different versions dependent on the printer model. All of the cartridges used are similar in design and the filling methods are exactly the same for each type.

KIT COMPONENTS

(Kit shown is Canon S9000/i9100 version)

1. Refillable cartridge set.
2. Drawing needles.
3. Gloves.
4. Filling syringes.
5. Instructions and profiles on CD.
6. Ink bottles. (Only supplied with ink kits)



STEP 1

Before starting the installation, print a good nozzle check print using the existing inks installed on your printer. Write the date on the print and keep it. No warranty claim regarding the refillable cartridges and inks will be accepted unless it is supported by a good nozzle check print produced before the installation. The utility for producing a nozzle check print can be found under the 'Maintenance' or 'Utilities' tab of the print driver software supplied with your printer.

STEP 2

All Ink2image refillable cartridges for Canon desk top printers have the same design as the original Canon cartridges. The design includes two chambers – Chamber A contains closed cell plastic foam that gets saturated with ink when the cartridge is filled. Chamber B is an ink reservoir that tops up chamber A as ink is used in the printer. Chamber A has an air hole in the top that is covered with tape when you receive the cartridge – THIS TAPE SHOULD NOT BE REMOVED UNTIL THE CARTRIDGE HAS BEEN FILLED FOR THE FIRST TIME. Chamber B has a filling hole in the top that contains a removable rubber bung. This bung should always be in the hole when the cartridge is being used in the printer.

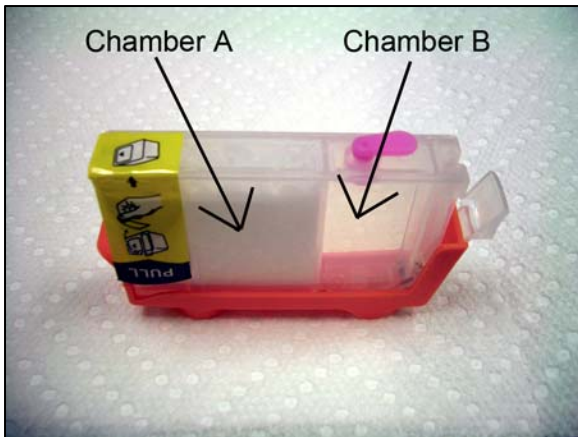

Cartridges are supplied with an orange cartridge holder/clip. This holder should not be discarded as it is a very useful aid when refilling a cartridge. Before starting the filling process, it is a good idea to familiarize your self with how a cartridge is removed from the holder and re-installed again.

Firstly, push down on the tab at the end of the orange clip/holder to release the cartridge.

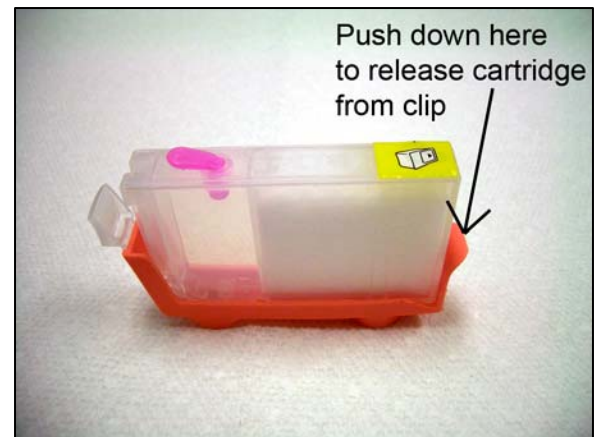

Next, lift up the cartridge and move it to the right, as in this picture.

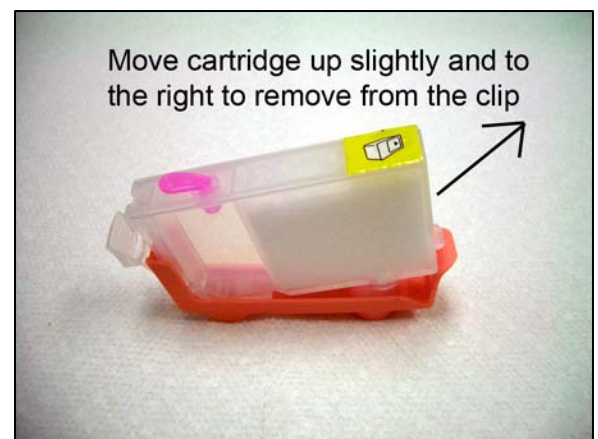

Continue moving the cartridge to the right while sliding the locking clip on the cartridge under the bar on the orange cartridge holder/clip. The cartridge can now be removed from the holder/clip.

To re-install a cartridge in the holder/clip, reverse the above process by passing the cartridge locking clip under the bar on the holder/clip, and then sliding the cartridge back into the clip until the tab at the end of the holder clicks back into place.

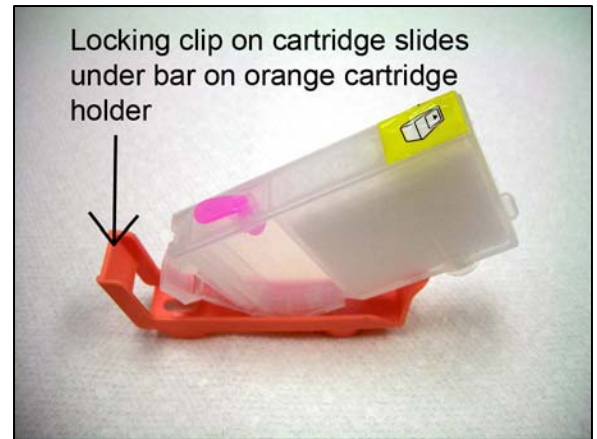

FILLING CARTRIDGES FOR THE FIRST TIME

The method for initially filling and refilling the cartridges is very similar. However, filling a cartridge for the first time is a little more involved as the foam in chamber A needs to be primed with ink for the cartridge to function correctly. Once this has been done then refilling the cartridge is simpler as the foam doesn't need priming again. Filling all the different cartridge types uses the same method with the exception of the ink types used and the cartridge capacities. The BCI-6 and CLI-8 design cartridges initially hold around 12 ml of ink and always use dye based inks. The BCI-3eBk and PGI-5Bk design black cartridges have an initial capacity of around 24 ml and use pigment black ink only.

STEP 3

When filling the cartridges, it is advisable to work with one ink bottle and cartridge at a time to reduce the possibility of knocking an open bottle over or of filling the wrong ink into the wrong cartridge.

Take a syringe and push a filling needle on to the tip of the syringe. Open the relevant color ink bottle and draw 5 ml of ink into the syringe for the BCI-6 and PGI-8 cartridge. For the BCI3-eBk and PGI-5Bk black cartridge, draw 10 ml of ink into the syringe. Remove the bung from the filling hole in chamber B, insert the syringe needle down into the cartridge, and gently inject the ink into chamber B until the chamber is filled to within $\frac{1}{4}$ " of the top. Remove the syringe from the cartridge and, if any ink remains in the syringe, return this ink to the ink bottle. Remove the needle from the syringe and place the needle on a piece of paper towel.



Insert the syringe tip (without needle fitted) firmly into the filling hole and pull up on the syringe plunger as far as it will go. Don't worry if any ink sucks back into the syringe.



Release the syringe plunger and you will see that the ink is sucked from chamber B into the foam in chamber A. All of the ink in chamber B should automatically transfer to chamber A, apart from a few bubbles as in this picture. For the larger capacity BCI-3EBk and PGI-5Bk, you may need to pull up on the plunger and release it a second time before all the ink is sucked into chamber A.



Remove the syringe from the cartridge, push the needle back on to the tip and draw up another 5 ml of ink from the ink bottle for the BCI-6 and PGI-8 cartridge. For the BCI3-eBk and PGI-5Bk black cartridge, draw 10 ml of ink into the syringe. Insert the syringe needle down into the cartridge, and gently inject the ink into chamber B until the chamber is filled to within $\frac{1}{4}$ " of the top. Again, remove the syringe from the cartridge and, if any ink remains in the syringe, return this ink to the ink bottle. Remove the needle from the syringe and place the needle on a piece of paper towel.

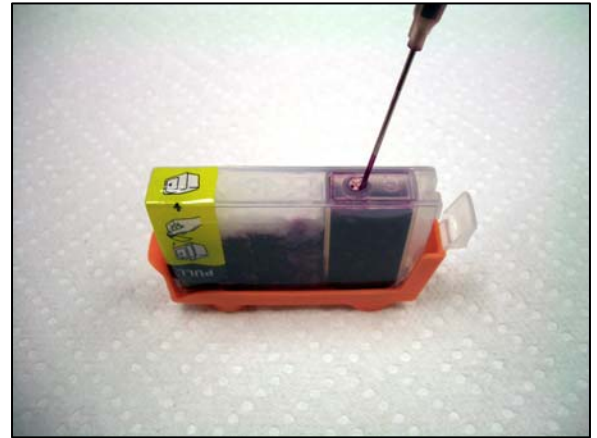

Again, insert the syringe tip (without needle fitted) firmly into the filling hole and pull up on the syringe plunger as far as it will go. Don't worry if any ink sucks back into the syringe.



Release the syringe plunger and you will see that more ink is sucked from chamber B into the foam in chamber A. Pull up on the syringe plunger again and release it. At this point, you should see that the foam in chamber A is pretty well saturated to the top with ink. For the larger capacity BCI-3EBk and PGI-5Bk black cartridge, you may need to pull up on the plunger and release it a third time before all the foam in chamber A is saturated to the top. Remove the syringe from the cartridge and return any ink in the syringe to the ink bottle.

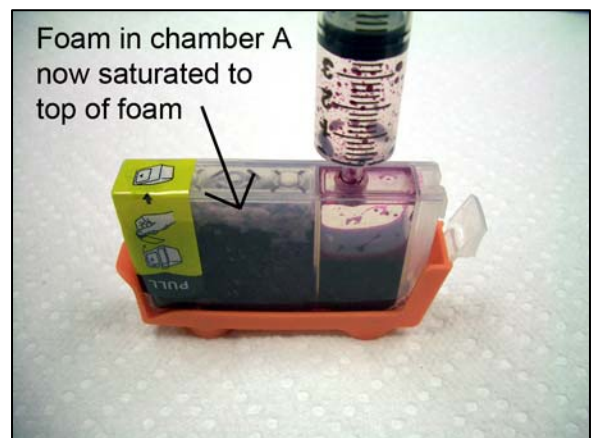

Push the needle back onto the syringe tip and draw 2 to 3 ml of ink into the syringe from the ink bottle (4 to 6 ml for the larger capacity BCI-3EBk and PGI-5Bk black cartridge). Insert the needle into the filling hole and gently inject ink until chamber B is filled to $\frac{1}{4}$ " from the top. Remove the syringe and return any ink to the ink bottle. Use a piece of paper towel to clean up any ink spillage from around the filling hole and push the rubber bung firmly back into the filling hole. The cartridge is now filled with ink and ready for use. Put the top back on the ink bottle. Rinse out the syringe and needle under a faucet, and store in a clean, safe place for when you need to refill the cartridge.



Repeat this initial filling process with each of the cartridges in turn using a clean syringe for each ink color, and ensuring you fill the correct color cartridge with the correct ink type. Some people get confused with the difference between cyan and photo cyan, and between magenta and photo magenta on the Canon printers. 'Photo' actually is the lighter shade of the cyan and magenta inks, so if you have ink bottles labeled with 'Light Cyan' or 'Light Magenta', these are used in the photo cyan and photo magenta cartridges respectively.

INSTALLING THE CARTRIDGES IN YOUR PRINTER

The Ink2image refillable cartridges are used in a printer just like normal cartridges. You can also use the refillable cartridges alongside original cartridges so you can use up these original cartridges. The tape over the air hole on the top of chamber A must be removed before installing a filled cartridge. After peeling off the tape, it is advisable to check that the air hole is not blocked by any adhesive remaining from the tape. The air hole should be clearly visible after removing the tape, as in this picture. If it looks like it is blocked or partially blocked, use a straightened out paperclip to pierce through any adhesive residue in the air hole. After you have removed the tape from the air hole,

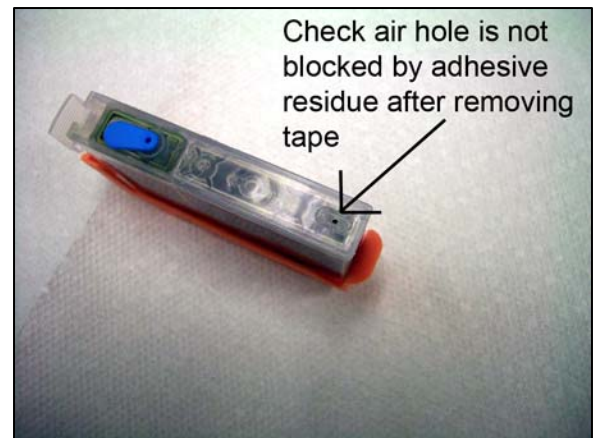

remove the cartridge from the orange holder/clip as explained earlier in these instructions. It is advisable to hold the cartridge upside down when removing the cartridge holder to stop any ink dripping from the bottom of the cartridge. Place the cartridge in the appropriate slot in the printer. Using paper towel, wipe any ink out from the bottom of the cartridge holder/clip and store in a clean, safe place for when you need to refill the cartridge. After installing a cartridge or cartridges, it is also advisable to perform a nozzle check print on the printer to ensure that all the jets are firing. Perform cleaning cycles as necessary until you get a good nozzle check print. Nozzle cleaning is not normally necessary if the cartridge has been filled correctly.

REFILLING THE REFILLABLE CARTRIDGES

The ink level monitor on your computer will warn you when a cartridge is running low or empty. A quick tip - we recommend refilling all the cartridges at the same time that show as running down on the ink monitor. The reason for this is that the Canon ink monitor software is not very representative of the actual ink levels in the cartridges – when a cartridge shows as half full on your computer it is in fact about a quarter full. If you wait until a cartridge is shown as empty each time before refilling, then you will find that you have to stop printing more often to refill individual cartridges. Refilling cartridges

is much simpler than the initial filling process above, as the foam in chamber A has already been primed with ink.

To refill the cartridges, follow this simple procedure:-

1. Remove all the cartridges that need refilling from the printer and insert each one back into an orange cartridge holder/clip. Make sure that the orange cartridge holder is clean before inserting the cartridge so that no ink contamination can occur.
2. Working with each cartridge and ink color in turn; remove the rubber bung from the ink filling hole. Take a clean syringe and push a clean needle on to the syringe tip. Fill the syringe with 5 ml of ink from the appropriate ink bottle for the BCI-6 or PGI-8 (10 ml for the BCI-3eBl or PGI-5Bk black cartridge) and gently inject the ink into chamber B of the cartridge. You will notice that the ink quite quickly transfers into the foam in chamber A. Wait 20 seconds or so for the ink to stop transferring from chamber B to A, refill the syringe from the ink bottle, and then top off chamber B to about ¼" from the top. Replace the bung in the ink filling hole and re-install the cartridge back in the printer. The amount of ink it takes to refill a cartridge will depend on how empty the cartridge was before you refilled it. For a BCI-6 or PGI-8 that registered as completely empty, it will take about 10 ml of ink to refill. For a completely empty BCI-3eBk or PGI-5Bk black cartridges it will take about 20 ml of ink to refill.
3. Always clean out the syringes and needles under a faucet after use and store them in a safe, clean place for next time. Remember to also wipe any ink out from the bottom of the orange holders after refilling.

CARTRIDGES WITH INK MONITOR CHIPS

Some Canon refillable cartridges such as the PGI-8 and PGI-5Bk have ink monitor chips fitted on them, just like original cartridges. These chips, however, reset to full automatically during the refilling process. The chips will reset to full when a cartridge ink level is showing as half full or lower in the ink monitor software, AND when the cartridge is removed from the printer. The chips will also reset when the ink level is shown as half full or lower by the ink monitor, AND the print head is moved to the cartridge change position (by opening the lid on most printer models). This is again why it is advisable to refill all cartridges at once that are showing as half full or lower on the ink monitor software. Otherwise, there is a chance that a half full cartridge chip will reset to full without it being refilled.

30 DAY GUARANTEE TO REPLACE DEFECTIVE PARTS

Ink2image guarantee all parts are defect-free for a period of 30 days from the date that you receive your refillable cartridge kit. If you have received a defective part, please initially contact the retailer or dealer from where the system was purchased.

DISCLAIMER

As refillable cartridges are self installed by the user, Ink2image is not responsible for any damages to your printer, whether they are or are not related to the refillable cartridges. Please contact the store or dealer where the printer was purchased, or the printer manufacturer for any problems or questions related to the printer and its operation.

If the Customer chooses to use ink in the cartridges from another manufacturer other than Ink2image, and is not satisfied with the ink, or it clogs the printer or the cartridges, it will be the Customers responsibility to pay for the parts to repair the system and restore it to normal usage. We can only guarantee that the refillable cartridges will deliver Ink2image ink just as well as a normal ink cartridge.

We will not accept returns of cartridges filled with third party ink that the customer later decides does not meet their specific needs.